



1A/1H/1M/1ZA series caps have a hinge-type retention system which gives a rocker-action actuation when mounted on Multimec 5G switch.

Illumination can be provided with 1A in transparent colours or 1H with different colour lenses.

1A/1H, 1ZA and 1M caps offer three different dimensions, many solid and transparent colours as well as lens colours. 1A has many legend options in its standard offering; however, all caps can be provided with custom legends.



*Letter legends on the picture are not standard

Distributor:

Technical Data:

- through-hole or SMD
- 50mA/24VDC
- single pole/momentary
- 10.000.000 operations lifetime
- IP67 sealing
- temp. range: switch: -40/+160°C
LED: -30/+85°C
solid keycap: -40/+65°C
transparent keycap: -40/+85°C
- actuation force: 2.0, 3.5, 6.5 N

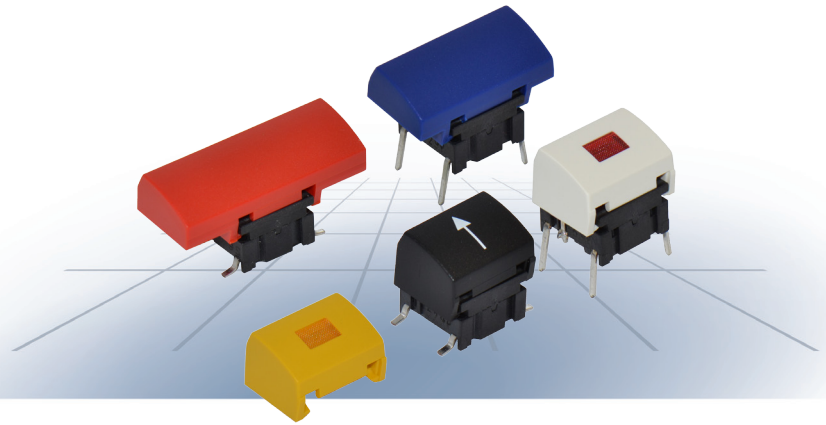

Dimensions (SMD w/LED) 1A

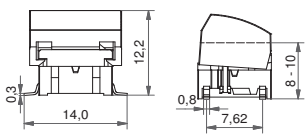

PCB layout

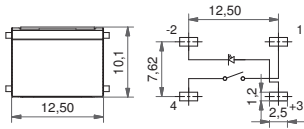

Dimensions (TH w/LED) 1H

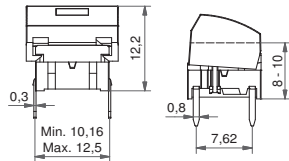

PCB layout

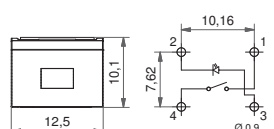

Dimensions (through-hole) 1ZA

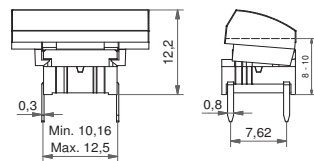

PCB layout

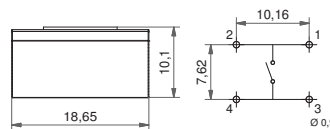

Dimensions (SMD) 1M

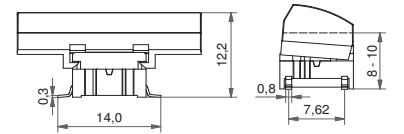

PCB layout

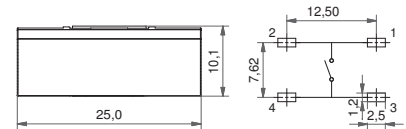

HOW TO ORDER illuminated

5 G				+				
Switch	Mounting	Actuation force	LED		Cap	Colour code 1H	Lens 1H	
TH9 through-hole	TH9 through-hole	20	01 blue		1H	00 blue 06 white	1 transparent	
SH9 surface mount	SH9 surface mount	35	22 green			02 green 08 red	2 green	
		65	42 yellow			03 grey 09 black	4 yellow	
		Q**	61 white			04 yellow	6 frosted white	
			82 red				8 red	
			2242 green/yellow		1A	Colour code 1A		
			8222 red/green			10 frosted blue 16 frosted white		
			8242 red/yellow			12 frosted green 18 frosted red		
						14 frosted yellow		

HOW TO ORDER non-illuminated

5 G				+			
Switch	Mounting	Actuation force	Cap		Colour code		
TH9 through-hole	TH9 through-hole	20	1A		00 blue 30*ultra blue 50*metal dark blue		
SH9 surface mount	SH9 surface mount	35			02 green 40*dusty blue 53*metal light grey		
		65	1ZA		03*grey 42*aqua blue 57*metal dark grey		
		Q**			04 yellow 32 mint green 58 metal bordeaux		
			1M		06*white 33 tele grey		
					08 red 34 melon		
					09*black 38 noble red * Colours for 1ZA		

**Quiet version is only available for actuation force 2.0N (20) and the letter Q is added to the end of the switch part number. See the ordering example.

Dimensions (mm) Unless otherwise specified, all tolerances +/- 0.2

Ordering example: 5GSH93582 + 1H068 with illumination
5GTH965 + 1ZA57 without illumination
**5GTH92001Q with illumination or 5GSH920Q (quiet version)

For updates of products and/or changes of specifications please see www.mec.dk

See colour codes on our website: www.mec.dk