

| LTR | EN | DESCRIPTION     | APPR | BY | DATE   |
|-----|----|-----------------|------|----|--------|
| A   | -  | INITIAL RELEASE | RB   | NH | 1-7-04 |

THD 3/8-27

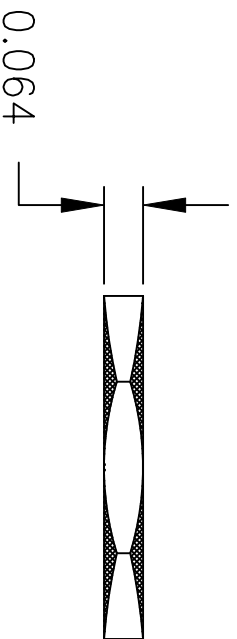
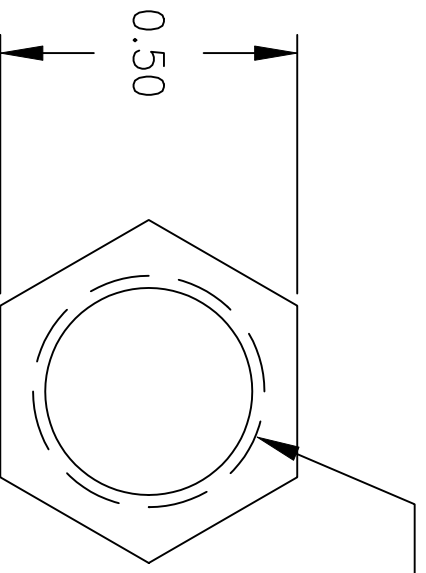

JUDCO INVENTORY NO. 18-1006-00  
 DESCRIPTION: NUT, HEX, 3/8-27, BRASS, UNPLATED

CUSTOMER: DIGI-KEY  
 CUSTOMER: PN 534PB-ND  
 ACCEPTED BY: \_\_\_\_\_  
 DATE: \_\_\_\_\_

DIMENSIONS IN INCHES  
 DIMENSIONS ARE REFERENCE

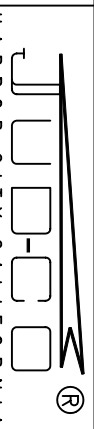

HARBOR CITY CALIFORNIA  
 TITLE NUT, HEX 3/8-27  
 BRASS, UNPLATED

DRAWN: NH 1-7-04  
 APPR: KJ 1-7-04

DWG. NO. 1415-543

1415US43A.DWG

SHEET

1 OF 1

This document embodies a product, component, and/or design proprietary to JUDCO MANUFACTURING INC., and which is protected either as a trade secret, by U.S. Patent, or by copyright. It may not be used in any way without written express consent of JUDCO MANUFACTURING INC.